



CORE ECLIPSE 10"

QUICK START GUIDE



PACKAGE CONTENTS

Core Eclipse 10" Touch Panel

Quick Start Guide

Connectors

Screws

DEVICE MODELS: CR-TS-07-BSC and CR-TS-07-KNX

DOCUMENT VERSION: 1.0

PRODUCT OVERVIEW

Core Eclipse is designed as all-in-one controller to meet needs for residential buildings. It works as smart home controller and monitoring panel, SIP Intercom Indoor Panel and Security Panel in today's and tomorrow's smart homes.

Smart Home Controller: Eclipse Panel can be connected to multiple interfaces to control and monitor smart devices from different protocols.

Intercom Indoor Panel: It is compatible with SIP Protocol which is mostly used communication protocol in IP intercom system. Thus Touch Panel can work as indoor Intercom Panel in SIP Intercom Networks.

Security Panel: Touch Panel has built-in digital inputs which can be connected to security sensors. Then Eclipse Panel can work as security panel to satisfy basic needs for security solutions.

FRONT VIEW

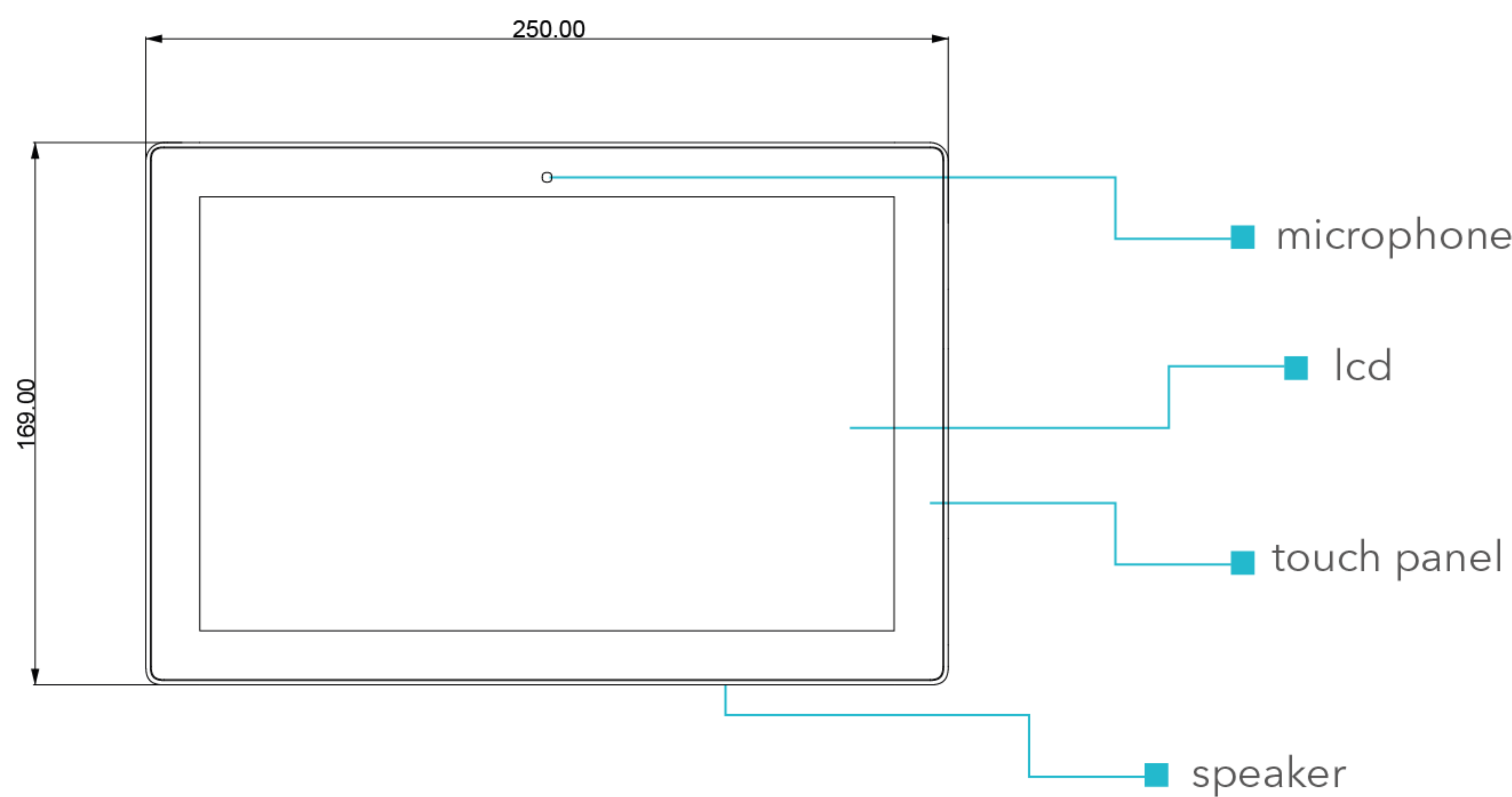

TOP VIEW

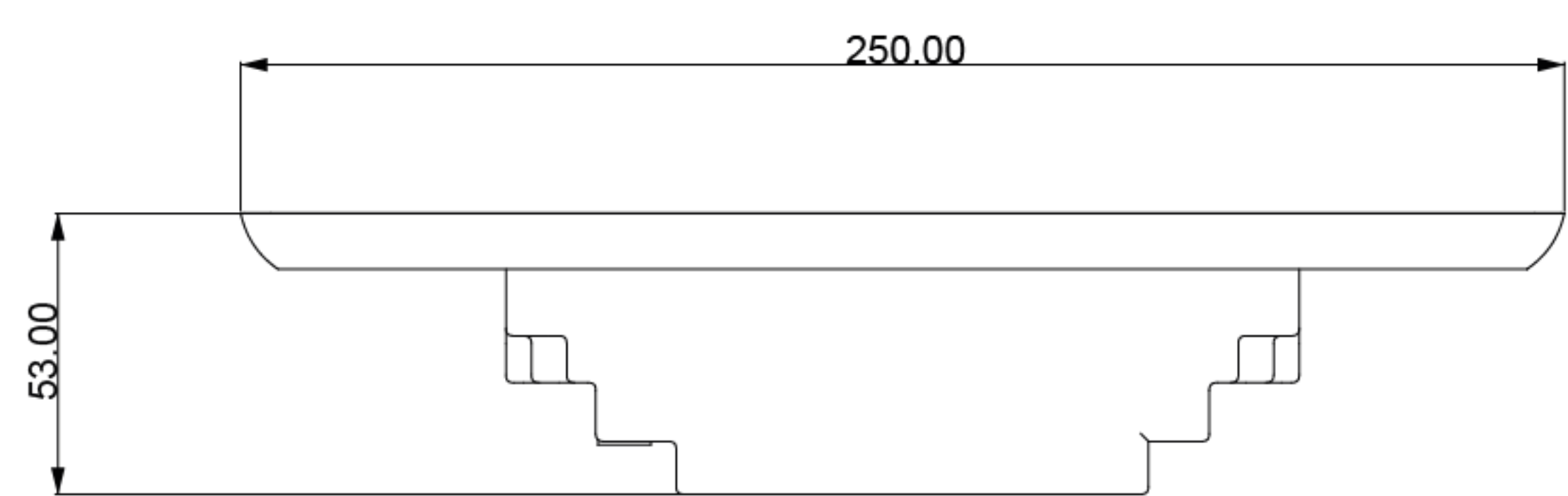

REAR VIEW

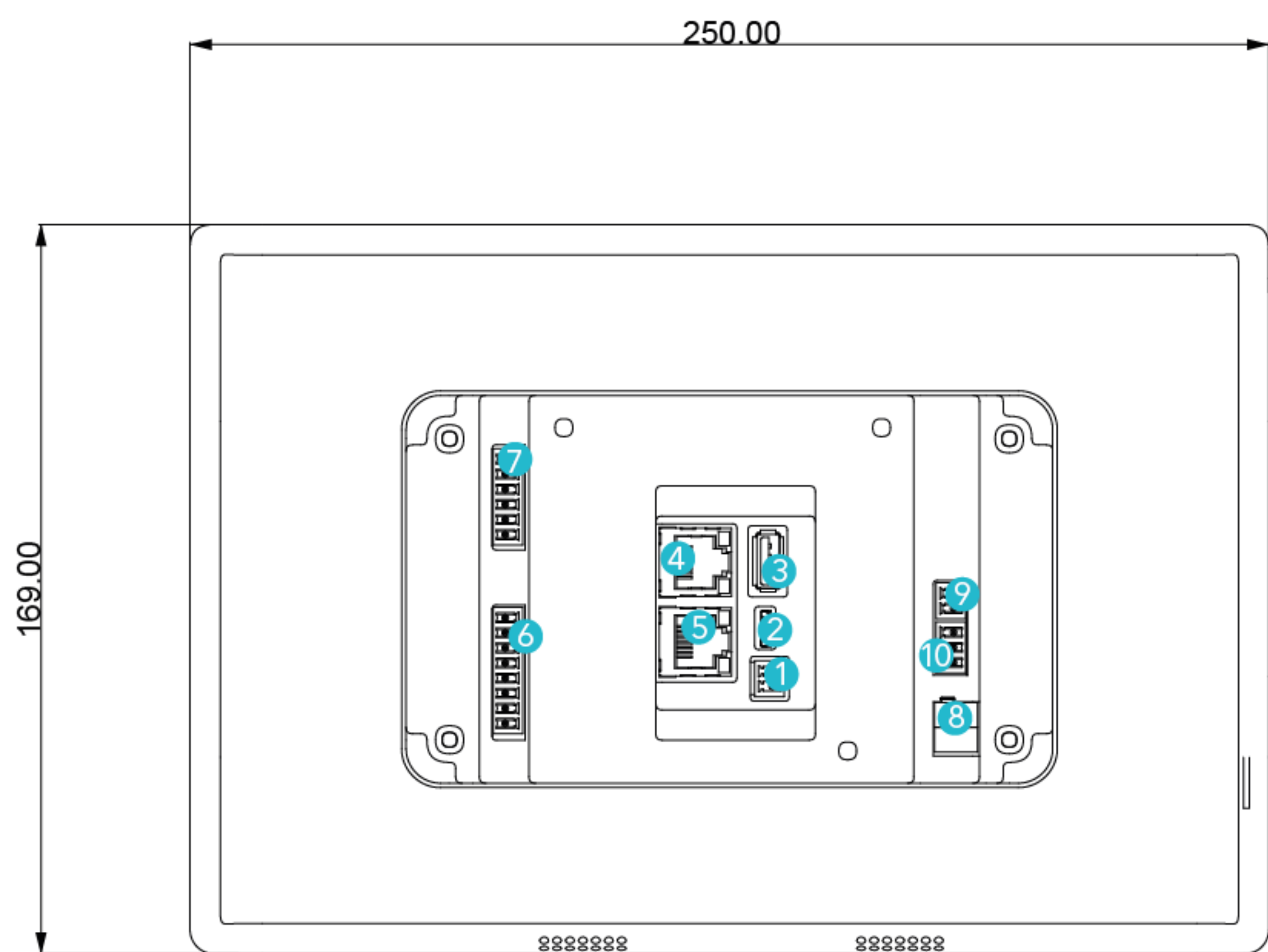

- 1. Power Supply: 12 VDC
- 2. USB Mini: Reserved for debugging
- 3. USB-C: Reserved for programming
- 4. ETH0: Building network. Connection to intercom clients, smart devices and internet access in building.
- 5. ETH1: Home network. Connection to smart devices, intercom clients and internet access at home
- 6. Outputs (Q1-Q4): 4 x 8A Latching Relay
- 7. Inputs (I1-I5): Digital Inputs
- 8. KNX: Connection to KNX-TP bus line
- 9. RS-485: Connection to RS-485 connected devices
- 10. RS-232: Connection to R-232 connected device

Note: Core Eclipse is able to connect to two different IP networks at the same time. This feature allows to isolate home and building networks in buildings.

CONFIGURATION

Eclipse Panel is configured via built-in web interface. It has dual Ethernet network interfaces which use DHCP by default.

- Connect Eclipse Panel to a network that has DHCP server via home or building network.
- Go to Settings in Eclipse Panel user interface and then get IP address of Eclipse Panel.
- Enter IP address to web-browser, then enter username and password
Default username: webAdmin Default password: wa1234
- If you need support in further steps, visit www.core.com.tr and check CoreOS Programming Manual.

INSTALLATION

1. Insert Core Eclipse 10" Inwall Box

- ⚠ Wall Box should be aligned horizontally
- ⚠ In-Wall box sold seperately.

Inwall box dimensions:
173,2mm x 103,2mm x 67 mm

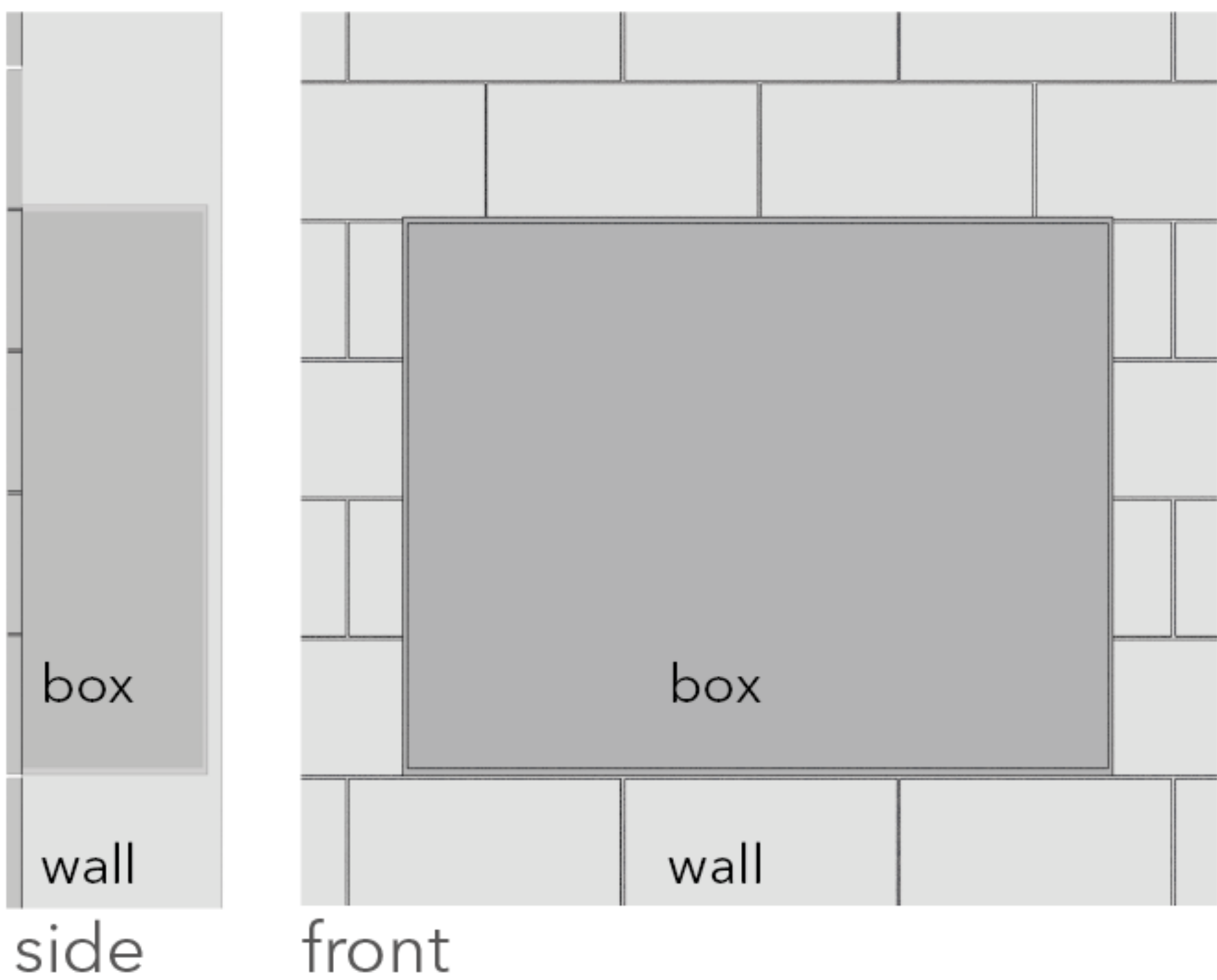

2. Connect cables to related connectors

 Switch off mains voltage before connecting cables

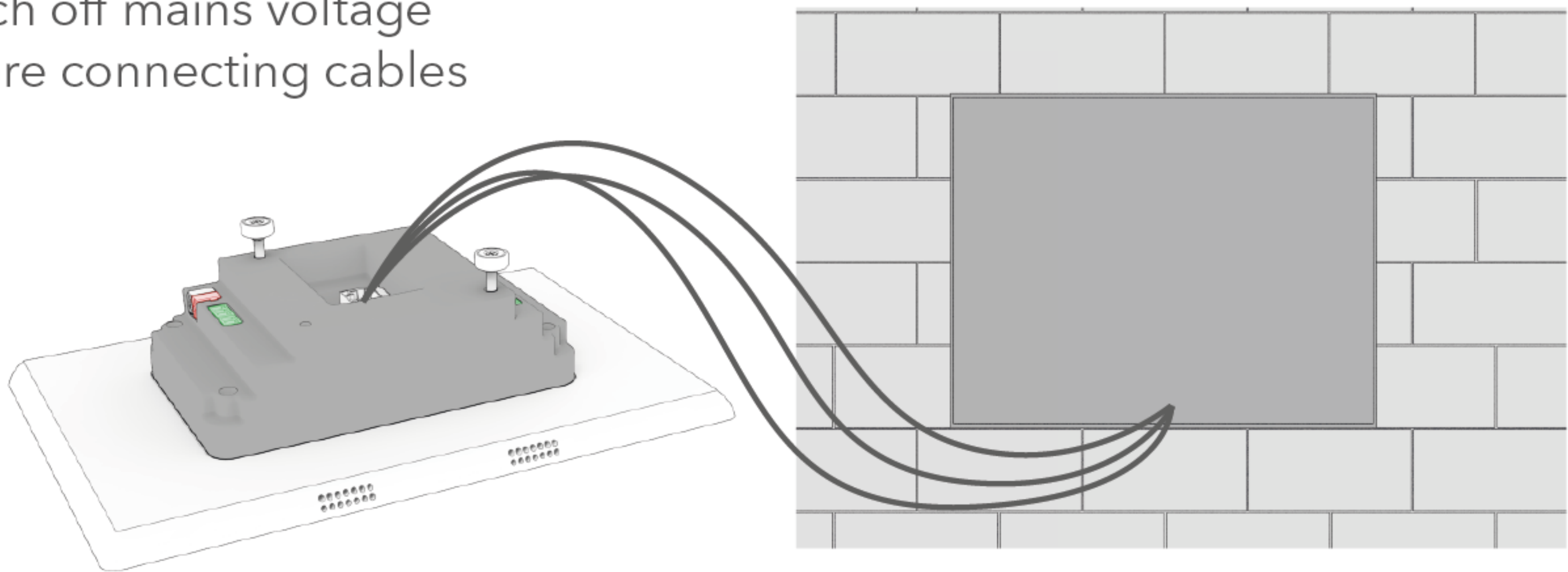

3. Adjust magnets for perfect fit



4. Mount Touch Panel

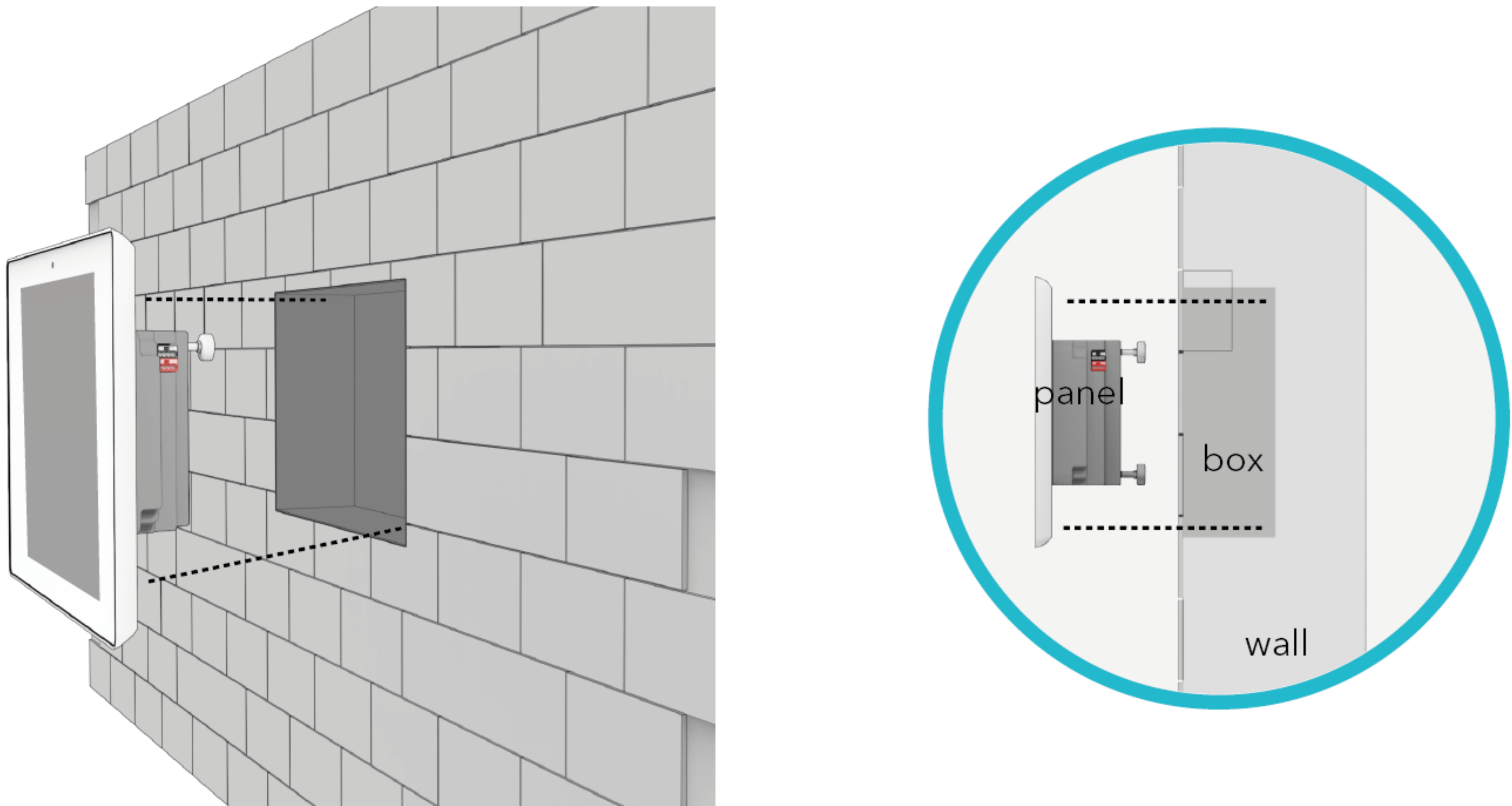

Manufactured by Kor Ev Otomasyon Sistemleri San.Tic.Ltd.Şti.
Address Fatih Mahallesi Ege Caddesi A2 Blok No:42/5 Gaziemir İzmir Türkiye
Core is trademark of KOR Ev Otomasyon Sistemleri San.Tic.Ltd.Şti.